



**IEC
BA STANDARDS**

INSULATED TERMINALS

AFTEC Range Terminals are designed to offer maximum Efficiency in heavy duty applications and to meet the increasing demands for improved safety and reliability of Electrical Connectors. AFTEC TERMINALS are polycarbonate insulations, Halogen free and self Extinguishing Thermoplastic Material. Aftec Terminals are manufactured from Electrolytic Copper, Rolled, Brazed Annealed and Tin Plated to Avoid corrosion. The Maximum Operating Temperature for AFTEC Terminals is 115°C (surge 130° C)

RING TERMINALS

FORK TERMINALS

FLANGED FORK TERMINALS

LOCKING FORK TERMINALS

HOOK TERMINALS

BLADE TERMINALS

HOOK BLADE TERMINALS

PIN TERMINALS

PIGGY BACK TERMINALS

PUSH-ONS MALE TERMINALS

PUSH-ONS FEMALE TERMINALS

MALE BULLET TERMINALS

FEMALE BULLET TERMINALS

SOCKET TERMINALS

ANGLE FEMALE FULLY INSULATED TERMINALS

SPLICE TERMINALS

PARALLEL SPLICE TERMINALS

FULL INSULATED MALE TERMINALS

FULL INSULATED FEMALE TERMINALS

PUSH-ONS TOTALLY FEMALE INSULATED TERMINALS

SCREW ON TERMINALS

END SPLICE TERMINALS

BOOTLACE FERRULES

TWIN BOOTLACE FERRULES

STRIP CONNECTORS

NON INSULATED BOOTLACE FERRULES

TERMINALS

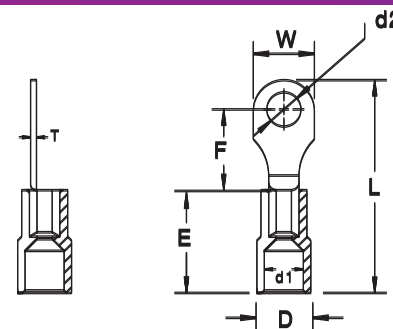

RING TERMINALS

Aftec Ring terminals are designed to offer maximum efficiency in heavy duty applications and to meet the increasing demands for improved safety and reliability of electrical connectors. Color coded insulation identifies the cable size. Ring tongue assures a secure connection in high vibration applications and brazed seam protects terminal barrel from splitting during the crimping process which cannot be removed unless mounting screw is removed.

Technical Data

Material : Electrolytic Copper
 Plating : Tin plated
 Insulation : Pvc (polyvinylchloride)
 Marking : Wire size and stud hole size mention on the tongue
 Color coding : According to wire sizes

MODEL NO.	WIRE RANGE		COLOR	STUD HOLE	DIMENSIONS						
	mm ²	AWG		D2	W	F	L	E	D	D1	T
				MM	MM	MM	MM	MM	MM	MM	MM
ARI 1.5-3.2	0.5-1.5	20-16	RED	3.2	5.6	5.0	17.5	10.0	4.0	1.7	0.75
ARI 1.5-3.7				3.7	5.6	5.0	17.5				
ARI 1.5-4.3				4.3	6.6	6.3	19.4				
ARI 1.5-5.3				5.3	8.0	7.0	20.8				
ARI 1.5-6.5				6.5	11.6	11.6	26.8				
ARI 1.5-8.5				8.5	11.6	11.0	26.8				
ARI 1.5-10				10.0	13.6	13.9	30.5				
ARI 1.5-12				12.0	18.1	16.0	35.4				
ARI 2.5-3.2	1.5-2.5	16-14	BLUE	3.2	6.6	4.8	17.8	10.0	4.5	2.3	0.80
ARI 2.5-3.7				3.7	6.6	4.8	17.8				
ARI 2.5-4.3				4.3	6.6	6.3	19.4				
ARI 2.5-5.3				5.3	8.5	7.8	21.8				
ARI 2.5-6.5				6.5	12.0	11.0	26.8				
ARI 2.5-8.5				8.5	12.0	11.0	26.8				
ARI 2.5-10				10.0	13.5	13.9	30.5				
ARI 2.5-12				12.0	18.1	16.0	35.4				
ARI 6-3.7	4.0-6.0	12-10	YELLOW	3.7	7.2	6.1	22.7	13.0	6.3	3.4	1.0
ARI 6-4.3				4.3	7.2	6.1	22.7				
ARI 6-5.3				5.3	9.5	9.1	26.6				
ARI 6-6.5				6.5	12.0	10.5	29.5				
ARI 6-8.5				8.5	15.0	13.5	34.0				
ARI 6-10				10.0	15.0	13.5	34.0				
ARI 6-12				12.0	18.5	16.0	38.6				

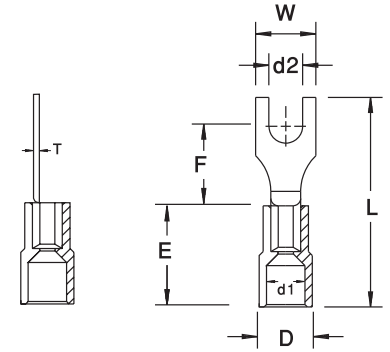

FORK TERMINALS

Aftec Fork terminals are designed to offer maximum efficiency in heavy duty applications and to meet the increasing demands for improved safety and reliability of electrical connectors. Color coded insulations identifies the cable size. Fork terminals enable easy and fast installation as the mounting screw does not have to be removed completely and brazed seam protects terminal barrel from splitting during the crimping process.

Technical Data

Material	: Electrolytic Copper
Plating	: Tin plated
Insulation	: Pvc (polyvinylchloride)
Marking	: Wire size and stud hole size mention on the tongue
Color coding	: According to wire sizes

MODEL NO.	WIRE RANGE		COLOR	STUD HOLE	DIMENSIONS						
	mm ²	AWG		D2	W	F	L	E	D	D1	T
				MM	MM	MM	MM	MM	MM	MM	MM
AFI 1.5-3.2	0.5-1.5	20-16	RED	3.2	5.7	6.5	21.0	10.0	4.0	1.7	0.75
AFI 1.5-3.7				3.7	5.7						
AFI 1.5-4.3				4.3	6.4						
AFI 1.5-5.3				5.3	8.1						
AFI 1.5-6.5				6.5	9.5						
AFI 2.5-3.2	1.5-2.5	16-14	BLUE	3.2	5.8	6.5	21.0	10.0	4.5	2.3	0.8
AFI 2.5-3.7				3.7	5.8						
AFI 2.5-4.3				4.3	6.4						
AFI 2.5-5.3				5.3	8.1						
AFI 2.5-6.5				6.5	9.5						
AFI 6-3.7	4.0-6.0	12-10	YELLOW	3.7	8.2	7.0	25.5	13.0	6.3	3.4	1.0
AFI 6-4.3				4.3	8.2	7.0	25.5				
AFI 6-5.3				5.3	9.0	7.0	25.5				
AFI 6-6.5				6.5	12.0	12.0	31.5				
AFI 6-8.5				8.5	14.0	10.5	30.5				

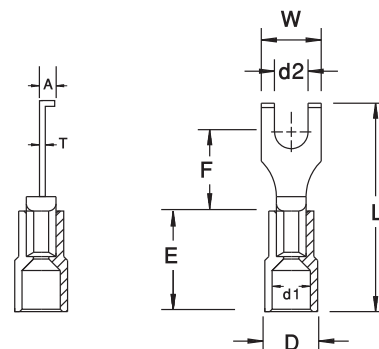

FLANGED FORK TERMINALS

Aftec Flanged Fork terminals are designed to offer maximum efficiency in heavy duty applications and to meet the increasing demands for improved safety and reliability of electrical connectors. Color coded insulation identifies the cable size. Flanged fork terminal locks in place and provides extra secure connection which also enables easy and fast installation as the mounting screw does not have to be removed completely and brazed seam protects terminal barrel from splitting during the crimping process.

Technical Data

Material : Electrolytic Copper
 Plating : Tin plated
 Insulation : Pvc (polyvinylchloride)
 Marking : Wire size and stud hole size mention on the tongue
 Color coding : According to wire sizes

MODEL NO.	WIRE RANGE		COLOR	STUD HOLE	DIMENSIONS							
	mm ²	AWG		D2	W	F	L	E	D	D1	A	T
				MM	MM	MM	MM	MM	MM	MM	MM	MM
AFFI 1.5-3.2	0.5-1.5	20-16	RED	3.2	7.5	5.1	19.0	10.0	4.0	1.7	1.5	0.75
AFFI 1.5-3.7				3.7	8.5	7.2	24.5					
AFFI 1.5-4.3				4.3	8.5	7.2	24.5					
AFFI 1.5-5.3				5.3	8.5	7.2	24.5					
AFFI 2.5-3.7	1.5-2.5	16-14	BLUE	3.7	8.5	7.2	23.0	10.0	4.5	2.3	1.5	0.8
AFFI 2.5-4.3				4.3	8.5							
AFFI 2.5-5.3				5.3	8.5							
AFFI 6-3.7	4.0-6.0	12-10	YELLOW	3.7	8.5	7.5	27.0	13.0	6.3	3.4	1.5	1.0
AFFI 6-4.3				4.3	8.5							
AFFI 6-5.3				5.3	8.5							

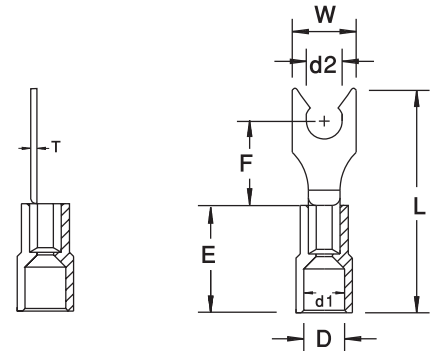

LOCKING FORK TERMINALS

Aftec Locking fork terminals are designed to offer maximum efficiency in heavy duty applications and to meet the increasing demands for improved safety and reliability of electrical connectors. Color coded insulation identifies the cable size. Locking fork terminals provides locks in place for secure connection which also enables easy and fast installation as the mounting screw does not have to be removed completely and brazed seam protects terminals barrel from splitting during the crimping process.

Technical Data

Material	: Electrolytic Copper
Plating	: Tin plated
Insulation	: Pvc (polyvinylchloride)
Marking	: Wire size and stud hole size mention on the tongue
Color coding	: According to wire sizes

MODEL NO.	WIRE RANGE		COLOR	STUD HOLE	DIMENSIONS						
	mm ²	AWG		D2	W	F	L	E	D	D1	T
				MM	MM	MM	MM	MM	MM	MM	MM
ALFI 1.5-3.7	0.5-1.5	20-16	RED	3.7	6.4	6.5	21.0	10.0	4.0	1.7	0.75
ALFI 1.5-4.3				4.3	8.1						
ALFI 1.5-5.3				5.3	9.5						
ALFI 2.5-3.7	1.5-2.5	16-14	BLUE	3.7	6.0	6.5	21.0	10.0	4.5	2.3	0.8
ALFI 2.5-4.3				4.3	8.1						
ALFI 2.5-5.3				5.3	9.3						
ALFI 6-3.7	4.0-6.0	12-10	YELLOW	3.7	8.3	7.0	25.2	13.0	6.3	3.4	1.0
ALFI 6-4.3				4.3	8.3	7.0	25.2				
ALFI 6-5.3				5.3	9.0	7.0	25.2				
ALFI 6-6.4				6.4	12.0	12.0	31.5				

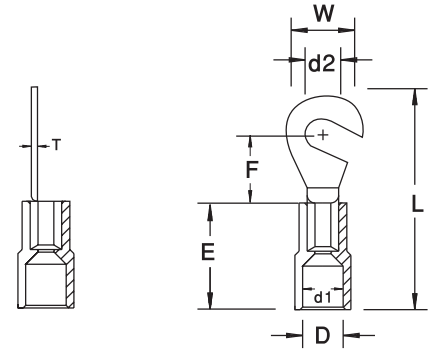

HOOK TERMINALS

Aftec Hook terminals are designed to offer maximum efficiency in heavy duty applications and to meet the increasing demands for improved safety and reliability of electrical connectors. Color coded insulation identifies the cable size. Hook terminal insulation support and helps to prevent wire damage in bending applications. Which also enables easy and fast installation as the mounting screw does not have to be removed completely and brazed seam protects terminals barrel from splitting during the crimping process.

Technical Data

Material : Electrolytic Copper
 Plating : Tin plated
 Insulation : Pvc (polyvinylchloride)
 Marking : Wire size and stud hole size mention on the tongue
 Color coding : According to wire sizes

MODEL NO.	WIRE RANGE		COLOR	STUD HOLE	DIMENSIONS						
	mm ²	AWG		D2	W	F	L	E	D	D1	T
				MM	MM	MM	MM	MM	MM	MM	MM
AHI 1.5-3.7	0.5-1.5	20-16	RED	3.7	8.0	7.0	20.8	10.0	4.0	1.7	0.75
AHI 1.5-4.3				4.3	8.0	7.0	20.8				
AHI 1.5-5.3				5.3	8.0	7.0	20.8				
AHI 1.5-6.5				6.5	11.6	11.0	26.8				
AHI 2.5-3.7	1.5-2.5	16-14	BLUE	3.7	8.5	7.8	21.8	10.0	4.5	2.3	0.8
AHI 2.5-4.3				4.3	8.5	7.8	21.8				
AHI 2.5-5.3				5.3	9.5	7.3	21.8				
AHI 2.5-6.5				6.5	12.0	11.0	26.8				
AHI 6-3.7	4.0-6.0	12-10	YELLOW	3.7	7.2	6.1	22.7	13.0	6.3	3.4	1.0
AHI 6-4.3				4.3	9.5	9.5	26.8				
AHI 6-5.3				5.3	9.5	9.5	26.8				
AHI 6-6.5				6.5	12.0	10.3	29.5				
AHI 6-8.5				8.5	15.0	13.5	34.0				

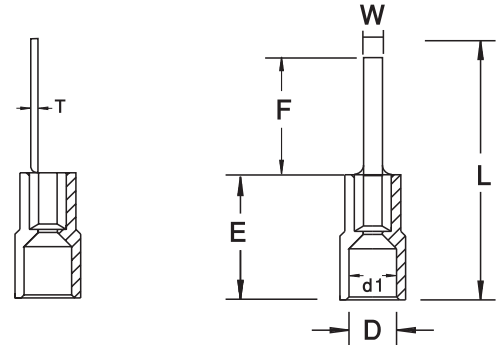

BLADE TERMINALS

Aftec Blade terminals are designed to offer maximum efficiency in heavy duty applications and to meet the increasing demands for improved safety and reliability of electrical connectors. Color coded insulation identifies the cable size. Blade terminals are designed to prevent damage to the wire over crimping, which are reliable electrical connections mostly used for terminal blocks. Which also enables easy and fast installation and brazed seam protects terminals barrel from splitting during the crimping process.

Technical Data

Material	: Electrolytic Copper
Plating	: Tin plated
Insulation	: Pvc (polyvinylchloride)
Marking	: Wire size mentioned on the tongue
Color coding	: According to wire sizes

MODEL NO.	WIRE RANGE		COLOR	DIMENSIONS						
	mm ²	AWG		W	F	L	E	D	D1	T
				MM	MM	MM	MM	MM	MM	MM
ABLI 1.5-8	0.5-1.5	20-16	RED	2.8	9.0	18.8	10.0	4.0	1.7	0.75
ABLI 1.5-10				2.3	10.0	19.8				
ABLI 1.5-12				3.0	12.0	20.8				
ABLI 1.5-14				3.0	14.0	23.8				
ABLI 1.5-18				2.2	18.0	27.8				
ABLI 2.5-8	1.5-2.5	16-14	BLUE	2.8	8.0	18.8	10.0	4.5	2.3	0.8
ABLI 2.5-10				2.4	10.0	19.8				
ABLI 2.5-14				3.0	14.0	23.8				
ABLI 2.5-18				2.8	18.0	27.8				
ABLI 6-10	4.0-6.0	12-10	YELLOW	2.8	10.0	23.0	13.0	6.3	3.4	1.0
ABLI 6-14				4.5	14.0	27.0				
ABLI 6-18				4.5	18.0	31.0				

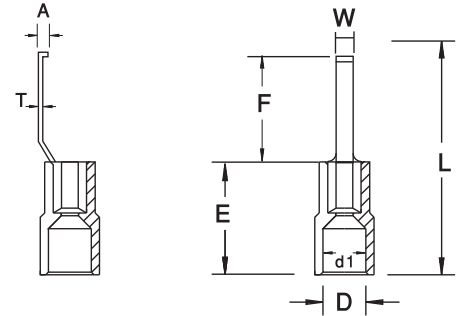
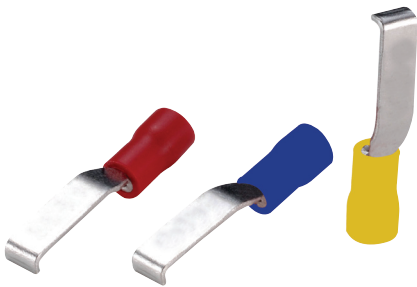

HOOK BLADE TERMINALS

Aftec Hook Blade terminals are designed to offer maximum efficiency in heavy duty applications and to meet the increasing demands for improved safety and reliability of electrical connectors. Color coded insulation identifies the cable size. Hook blade terminals insulation supports and helps to prevent wire damage in bending application.

Technical Data

Material : Electrolytic Copper
 Plating : Tin plated
 Insulation : Pvc (polyvinylchloride)
 Marking : Wire size and blade width mention on the tongue
 Color coding : According to wire sizes

MODEL NO.	WIRE RANGE		COLOR	DIMENSIONS							
	mm ²	AWG		W	F	L	E	D	D1	A	T
				MM	MM	MM	MM	MM	MM	MM	MM
AHBLI 1.5-3.0	0.5-1.5	20-16	RED	3.0	16.8	27.2	10.0	4.0	1.7	2.1	0.75
AHBLI 1.5-4.6				4.6							
AHBLI 2.5-3.0	1.5-2.5	16-14	BLUE	3.0	16.8	27.2	10.0	4.5	2.3	2.1	0.80
AHBLI 2.5-4.6				4.6							
AHBLI 6-3.0	4.0-6.0	12-10	YELLOW	3.0	17.2	30.2	13.0	6.3	3.4	2.4	1.0
AHBLI 6-4.6				4.6							

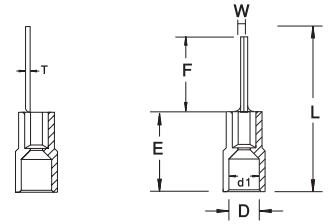

PIN TERMINALS

Aftec Pin terminals are designed to offer maximum efficiency in heavy duty applications and to meet the increasing demands for improved safety and reliability of electrical connectors. Color coded insulation identifies the cable size. Pin terminal are designed to prevent damage to the wire over crimping, which are reliable electrical connections mostly used for terminal blocks. Which also enables easy and fast installation and brazed seam protects terminals barrel from splitting during the crimping process.

Technical Data

Material : Electrolytic Copper
 Plating : Tin plated
 Insulation : Pvc (polyvinylchloride)
 Marking : Wire size and stud hole size mention on the tongue
 Color coding : According to wire sizes

MODEL NO.	WIRE RANGE		COLOR	DIMENSIONS							
	mm ²	AWG		W	F	L	E	D	D1	T	
				MM	MM	MM	MM	MM	MM	MM	
API 1.5-10	0.5-1.5	20-16	RED	1.9		10	19.8	10	4.0	1.7	0.75
API 1.5-12						12	21.8				
API 1.5-14						14	23.8				
API 1.5-18						16	25.8				
API 2.5-10	1.5-2.5	16-14	BLUE	1.9		10	19.8	10	4.5	2.3	0.80
API 2.5-12						12	21.8				
API 2.5-16						16	26.0				
API 2.5-18						18	28.0				
API 6-13	4.0-6.0	12-10	YELLOW	2.8	14	27.0	13	6.3	3.4	1.0	

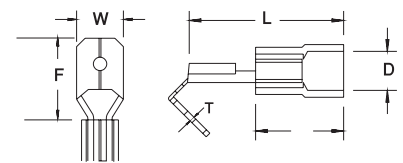

PIGGY BACK TERMINALS

Aftec Piggy back terminals are combination of female disconnect and male tab allows versal connection. Unique construction of the female disconnects offers longer term dependability, Color coded insulation indentifies the cable size. Brazed seam serrated barrel provides maximum tensile strength.

Technical Data:

Material : 70% Copper with brass
 Plating : Tin plated
 Insulation : Pvc (polyvinylchloride)
 Color coding : According to wire sizes

MODEL NO.	WIRE RANGE		COLOR	DIMENSIONS					
	mm ²	AWG		W	F	L	B	D	T
				MM	MM	MM	MM	MM	MM
APBI 1.5-6.3	0.5-1.5	20-16	RED	6.6	6.35	22.5	10.5	3.8	0.40
APBI 2.5-6.3	1.5-2.5	16-14	BLUE	6.6	6.35	22.5	10.5	4.7	0.40
APBI 6-6.3	4.0-6.0	12-10	YELLOW	6.6	6.35	24.0	13.0	6.2	0.40

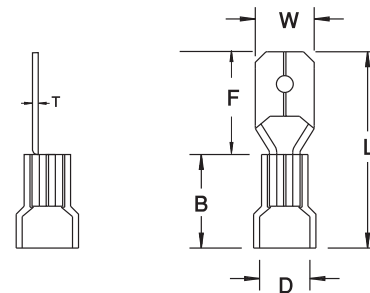

PUSH-ONS MALE TERMINALS

Aftec Push on male terminals connects with push on female terminals for disconnects which can be inserted and easily removed to install without the use of tools, Color coded insulation identifies the cable size. Brazed seam serrated barrel provides maximum tensile strength.

Technical Data

Material : 70% Copper with brass
 Plating : Tin plated
 Insulation : Pvc (polyvinylchloride)
 Marking : Wire size and stud hole size mention on the tongue
 Color coding : According to wire sizes

MODEL NO.	WIRE RANGE		COLOR	DIMENSIONS					
	mm ²	AWG		W	F	L	B	D	T
				MM	MM	MM	MM	MM	MM
APOMI 1.5-2.8	0.5-1.5	20-16	RED	2.8	6.5	19.2	10.5	3.8	0.50
APOMI 1.5-4.8				4.8	6.7	19.8			
APOMI 1.5-6.35				6.35	7.7	21.8			
APOMI 2.5-4.8	1.5-2.5	16-14	BLUE	4.8	6.7	19.8	10.5	4.7	0.50
APOMI 2.5-6.35				6.35	7.7	21.8			
APOMI 6-6.35	4.0-6.0	12-10	YELLOW	6.35	7.7	24.0	13.0	6.2	0.40

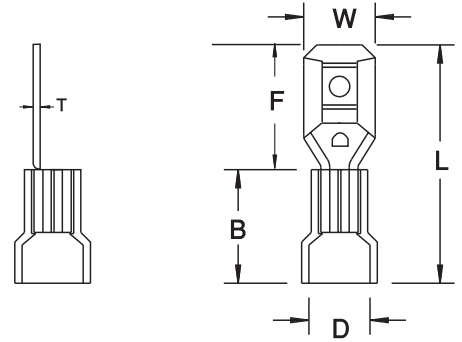

PUSH-ONS FEMALE TERMINALS

Aftec Push on female terminals connects with push on male terminals for disconnects which can be inserted and easily removed to install without the use of tools, Color coded insulation identifies the cable size. Brazed seam serrated barrel provides maximum tensile strength.

Technical Data:

Material : 70% Copper with brass
 Plating : Tin plated
 Insulation : Pvc (polyvinylchloride)
 Marking : Wire size and stud hole size mention on the tongue
 Color coding : According to wire sizes

MODEL NO.	WIRE RANGE		COLOR	DIMENSIONS					
	mm ²	AWG		W	F	L	B	D	T
				MM	MM	MM	MM	MM	MM
APFI 1.5-2.8	0.5-1.5	20-16	RED	3.2	6.5	19.0	10.5	3.8	0.40
APFI 1.5-4.8				5.0	6.4	19.4			
APFI 1.5-6.3				6.6	7.3	20.8			
APFI 2.5-2.8	1.5-2.5	16-14	BLUE	3.2	6.5	19.0	10.5	4.7	0.40
APFI 2.5-4.8				5.0	6.4	19.4			
APFI 2.5-6.3				6.6	7.3	20.8			
APFI 2.5-8.0				8.2	10.0	24.5			
APFI 6-4.8	4.0-6.0	12-10	YELLOW	5.0	6.5	22.0	13.0	6.2	0.50
APFI 6-6.3				6.6	7.3	23.3			
APFI 6-8.0				8.2	10.0	27.0			
APFI 6-9.5				10.0	12.0	28.6			

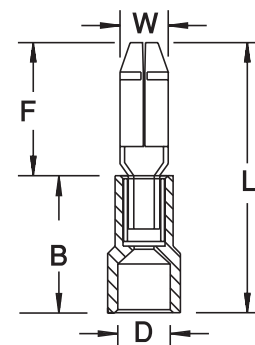

MALE BULLET TERMINALS

Aftec male bullet terminals connect with female bullets terminals for disconnects which can be inserted and easily removed to install without the use of tools, Color coded insulation identifies the cable size. Brazed seam serrated barrel provides maximum tensile strength.

Technical Data:

Material : 70% Copper with brass
 Plating : Tin plated
 Insulation : Pvc (polyvinylchloride)
 Color coding : According to wire sizes

MODEL NO.	WIRE RANGE		COLOR	DIMENSIONS					
	mm ²	AWG		W	F	L	B	D	T
				MM	MM	MM	MM	MM	MM
ABMI 1.5-4.0	0.5-1.5	20-16	RED	4.0	8.5	21.5	10.5	3.8	0.40
ABMI 2.5-4.0	1.5-2.5	16-14	BLUE	4.0	8.5	21.7	10.5	4.7	0.40
ABMI 2.5-5.0				5.0	8.5	21.7	10.5	4.7	0.40
ABMI 6-5.0	4.0-6.0	12-10	YELLOW	5.0	8.5	24.0	13.0	6.2	0.40

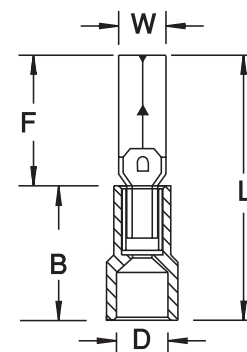

FEMALE BULLET TERMINALS

Aftec female bullet terminals connect with push on male bullet terminals for disconnects which can be inserted and easily removed to install without the use of tools, Color coded insulation identifies the cable size. Brazed seam serrated barrel provides maximum tensile strength.

Technical Data:

Material : 70% Copper with brass
 Plating : Tin plated
 Insulation : Pvc (polyvinylchloride)
 Color coding : According to wire sizes

MODEL NO.	WIRE RANGE		COLOR	DIMENSIONS					
	mm ²	AWG		W	F	L	B	D	T
				MM	MM	MM	MM	MM	MM
ABFI 1.5-4.0	0.5-1.5	20-16	RED	3.9	7.3	22.0	10.5	3.8	0.40
ABFI 2.5-4.0	1.5-2.5	16-14	BLUE	3.9	7.3	22.0	10.5	4.7	0.40
ABFI 6-5.0	4.0-6.0	12-10	YELLOW	4.9	7.0	24.5	13.0	6.2	0.40

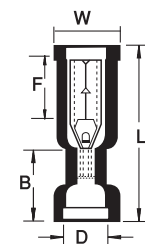

SOCKET TERMINALS

Aftec Socket terminals are combination of female disconnect which are designed to offer maximum efficiency in heavy duty applications and to meet the increasing demands for improved safety and reliability of electrical connectors. Color coded insulation identifies the cable size. Socket terminals brazed seam to prevent barrel separation.

Technical Data

Material : Brass
 Plating : Tin plated
 Insulation : Pvc (Polyvinylchloride)
 Color coding : According to wire sizes

MODEL NO.	WIRE RANGE		COLOR	DIMENSIONS					
	mm ²	AWG		W	F	L	B	D	T
				MM	MM	MM	MM	MM	MM
AST 1.5-4.0	0.5-1.5	20-16	RED	3.9	7.3	23.3	10.5	3.8	0.40
AST 2.5-4.0	1.5-2.5	16-14	BLUE	3.9	7.3	23.3	10.5	4.7	0.40
AST 2.5-5.0				4.9	7.0	23.3	10.5	4.7	0.40
AST 6-5.0	4.0-6.0	12-10	YELLOW	4.9	7.0	25.1	12.5	6.2	0.45

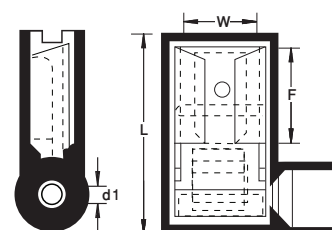
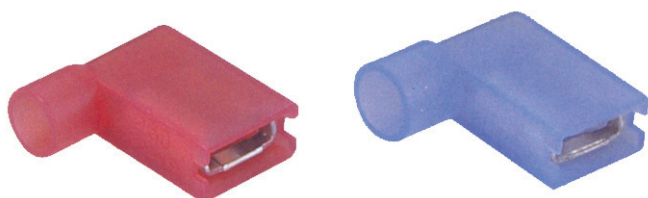

ANGLE FEMALE FULLY INSULATED TERMINALS

Aftec Angle female fully insulated terminals are designed for use in limited space area application and connect with male terminals for disconnects which can be inserted and easily removed to install without the use of tools, Color coded insulation identifies the cable size.

Technical Data

Material : 70% Copper with brass
 Plating : Tin plated
 Insulation : Pvc (Polyvinylchloride)
 Color coding : According to wire sizes

MODEL NO.	WIRE RANGE		COLOR	DIMENSIONS				
	mm ²	AWG		W	F	L	D	T
				MM	MM	MM	MM	MM
AAFI 1.5-4.8	0.5-1.5	20-16	RED	5.0	7.0	15.0	1.6	0.40
AAFI 1.5-6.3				6.6	7.6	15.2		
AAFI 2.5-4.8	1.5-2.5	16-14	BLUE	5.0	7.0	15.2	2.1	0.40
AAFI 2.5-6.3				6.6	7.6	15.2		

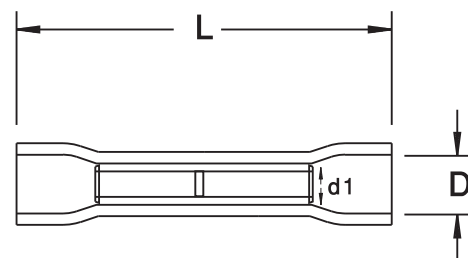

SPLICE TERMINALS

Aftec Splice terminals are designed to splice two stranded wires together to repair or lengthen wires and crimped at each end of the splice and are used in limited space area. Color coded insulation identifies the cable size. Brazed seam protects terminal barrel from splitting during the crimping process.

Technical Data

Material : Electrolytic Copper
 Plating : Tin plated
 Insulation : Pvc (Polyvinylchloride)
 Color coding : According to wire sizes

MODEL NO.	WIRE RANGE		COLOR	DIMENSIONS		
	mm ²	AWG		L	D	D1
				MM	MM	MM
ASI 1.5	0.5-1.5	20-16	RED	24.6	4.0	1.7
ASI 2.5	1.5-2.5	16-14	BLUE	24.6	4.5	2.3
ASI 6.0	4.0-6.0	12-10	YELLOW	26.5	6.3	3.4

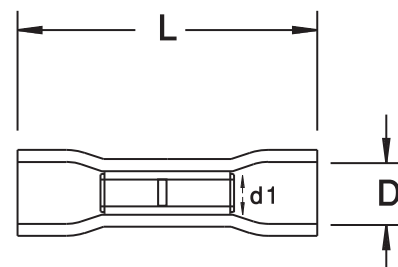

PARALLEL SPLICE TERMINALS

Aftec Parallel splice terminals are designed to splice two stranded wires side by side to repair or lengthen wires and crimped once. Color coded insulation identifies the cable size. Brazed seam protects terminal barrel from splitting during the crimping process.

Technical Data

Material : Electrolytic Copper
 Plating : Tin plated
 Insulation : Pvc (Polyvinylchloride)
 Color coding : According to wire sizes

MODEL NO.	WIRE RANGE		COLOR	DIMENSIONS		
	mm ²	AWG		L	D	D1
				MM	MM	MM
APSI 1.5	0.5-1.5	20-16	RED	13.0	4.0	1.7
APSI 2.5	1.5-2.5	16-14	BLUE	13.0	4.5	2.3
APSI 6.0	4.0-6.0	12-10	YELLOW	15.0	6.3	3.4

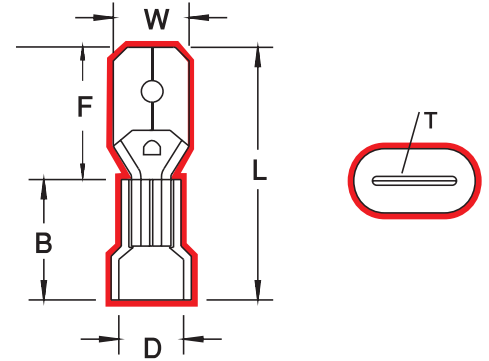

FULL INSULATED MALE TERMINALS

Aftec fully insulated male terminals connect with female terminals for disconnects which can be inserted and easily removed without the use of tools. Fully insulated terminals are designed for maximum stable connection providing higher quality connection, Color coded insulation identifies the cable size. Brazed seam serrated barrel provides maximum tensile strength.

Technical Data

Material : 70% copper with brass
 Plating : Tin plated
 Insulation : Polyamide
 Color coding : According to wire sizes

MODEL NO.	WIRE RANGE		COLOR	DIMENSIONS					
	mm ²	AWG		W	F	L	B	D	T
				MM	MM	MM	MM	MM	MM
AFIM 1.5-6.5	0.5-1.5	20-16	RED	6.35	7.7	23	11.0	4.0	0.40
AFIM 2.5-6.5	1.5-2.5	16-14	BLUE	6.35	7.7	24	11.0	4.5	0.40
AFIM 6-6.5	4.0-6.0	12-10	YELLOW	6.35	7.7	25	13.0	6.3	0.40

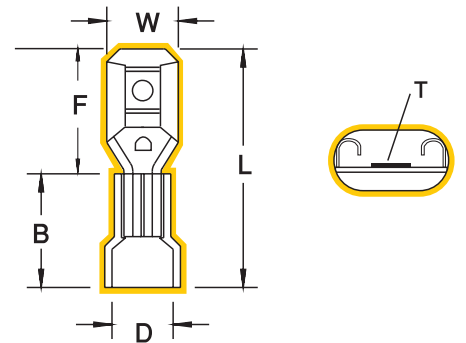

FULL INSULATED FEMALE TERMINALS

Aftec fully insulated female terminals connect with male terminals for disconnects which can be inserted and easily removed without the use of tools. Fully insulated terminals are designed for maximum stable connection providing higher quality connection, Color coded insulation identifies the cable size. Brazed seam serrated barrel provides maximum tensile strength.

Technical Data

Material : 70% copper with brass
 Plating : Tin plated
 Insulation : Polyamide
 Color coding : According to wire sizes

MODEL NO.	WIRE RANGE		COLOR	DIMENSIONS					
	mm ²	AWG		W	F	L	B	D	T
				MM	MM	MM	MM	MM	MM
AFIF 1.5-6.6	0.5-1.5	20-16	RED	6.6	7.3	22	11.0	4.0	0.40
AFIF 2.5-6.6	1.5-2.5	16-14	BLUE	6.6	7.3	22	11.0	4.5	0.40
AFIF 6-6.6	4.0-6.0	12-10	YELLOW	6.6	7.3	24	13.0	6.3	0.40

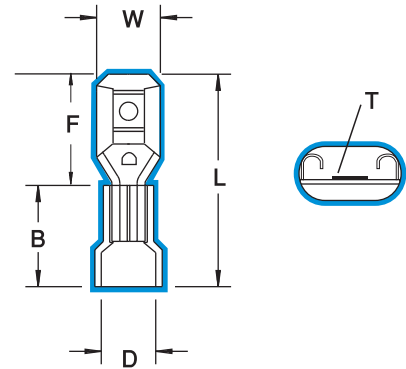

PUSH ONS TOTALLY FEMALE INSULATED TERMINALS

Aftec push on totally female insulated terminals connect with male terminals for disconnects which can be inserted and easily removed without the use of tools. Nylon insulation retains its shape when crimped and provides a firm grip around the wire insulation for maximum strain relief and also designed which provides protection from electrical shorts, Color coded insulation identifies the cable size.

Technical Data

Material : 70% copper with brass
 Plating : Tin plated
 Insulation : Polyamide
 Color coding : According to wire sizes

MODEL NO.	WIRE RANGE		COLOR	DIMENSIONS					
	mm ²	AWG		W	F	L	B	D	T
				MM	MM	MM	MM	MM	MM
APOI 1.5-2.8TI	0.5-1.5	20-16	RED	3.2	6.5	19.0	10.5	3.8	0.30
APOI 1.5-4.8TI				5.0	6.4	20.5			0.40
APOI 1.5-6.3TI				6.6	7.3	21.8			0.40
APOI 2.5-2.8TI	1.5-2.5	16-14	BLUE	3.2	6.5	19.0	10.5	4.7	0.30
APOI 2.5-4.8TI				5.0	6.4	20.2			0.40
APOI 2.5-6.3TI				6.6	7.3	22.2			0.40
APOI 6-6.3TI	4.0-6.0	12-10	YELLOW	6.6	7.3	24.2	12.5	6.2	0.40

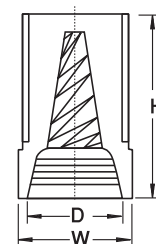

SCREW ON TERMINALS

Aftec screw on terminals is used for general wiring use which is quick and easy to use. Color coding indicates the right connector to the size of wire as shown in the chart below.

- ASC1 (Grey): 22-16 AWG (Three to Five #22 AWG; Two to Four #20 AWG; Two or Three #18 AWG; Two #16 AWG)
- ASC2 (Blue): 22-16 AWG (Five #22 AWG; Three to Five #20 AWG; Two or Four #18 AWG; Two or Three #16 AWG; One # 14 AWG w/On #16 AWG)
- ASC3 (Orange): 22-14 AWG (Five #22 AWG; Three to Five #20 AWG; Two to Five #18 AWG; Two or Three #16 AWG; Two #14 AWG)
- ASC4 (Yellow): 22-12 AWG (Four or Five #22 AWG; Three to Five #20 AWG; Two to Seven #18 AWG; Two to Four #16 AWG; Two or Three #14 AWG; Two #12 AWG)
- ASC5 (Red): 18-10 AWG (Three to Nine #18 AWG; Two to Six #14 AWG; Two to Four #12 AWG; Two or Three #10 AWG)

MODEL NO.	WIRE RANGE		COLOR	DIMENSIONS		
	mm ²	AWG		H	W	D
				MM	MM	MM
ASC1	0.34 - 1.5	22 - 16	GREY	15	8.7	6.5
ASC2	0.34 - 1.5	22 - 16	BLUE	18	10.0	7.5
ASC3	0.34 - 2.5	22 - 14	ORANGE	23	11.2	9.5
ASC4	0.34 - 4	22 - 12	YELLOW	24.2	13.6	10.8
ASC5	0.75 - 6	18 - 10	RED	27.8	16.1	12.7

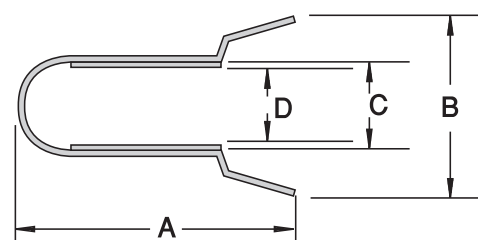

END SPLICE TERMINALS

Aftec End splice terminals accommodate multiple wire sizes in varying combinations. Internal barrel beveled to provide quick and easy wire insertion. Ideal for harsh environments and provides excellent chemical impact and abrasion resistance.

Technical Data

Material : Brass
 Plating : Tin plated
 Insulation : Polyamide

MODEL NO.	WIRE RANGE		COLOR	DIMENSIONS			
	mm ²	AWG		A	B	C	D
				MM	MM	MM	MM
AESI 1.5	0.5-1.5	20-16	WHITE	17.8	7.2	3.6	2.5
AESI 2.5	1.5-2.5	16-14	WHITE	21.0	8.2	4.0	2.9
AESI 6.0	4.0-6.0	12-10	WHITE	22.5	9.0	4.8	3.9

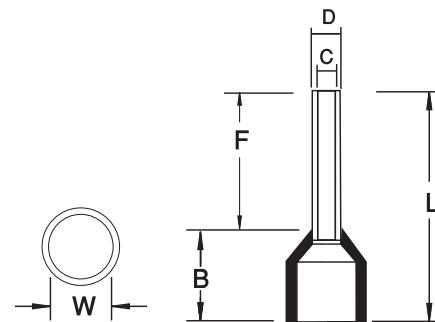

BOOTLACE FERRULES

Aftec Bootlace ferrules ensure reliable electrical connectors when terminating conductors in screw clamp terminal blocks. Color coding of the insulation is according to the wire size and the country standard. Designed with seamless barrel to contain loose wire strands for separator terminations which are easy to use by stripping the wire and sliding on to the end wire and crimping suitable for limited space panel applications.

Technical Data

Material : Copper

Plating : Tin plated

Insulation : Polyamide

MODEL NO.	WIRE RANGE		COLOR		DIMENSIONS					
	mm ²	AWG			F	L	W	B	D	C
					MM	MM	MM	MM	MM	MM
ABF 0.5-8	0.5	20	WHITE	ORANGE	8	14	3.2	6.0	1.3	1.0
ABF 0.5-12					12	18				
ABF 0.75-8	0.75	18	WHITE	BLUE	8	14	3.2	6.0	1.5	1.2
ABF 0.75-12					12	18				
ABF 1.0-8	1.0	17	RED	YELLOW	8	15	3.7	7.0	1.7	1.4
ABF 1.0-10					10	17				
ABF 1.0-12					12	19				
ABF 1.0-18					18	25				
ABF 1.5-8	1.5	16	RED	BLACK	8	15	4.0	7.0	2.0	1.7
ABF 1.5-10					10	17				
ABF 1.5-12					12	19				
ABF 1.5-18					18	25				
ABF 2.5-12	2.5	14	BLUE	GREY	12	19	5.0	7.0	2.6	2.3
ABF 2.5-18					18	25				
ABF 4.0-12	4.0	12	GREY	YELLOW	12	20	6.0	8.0	3.2	2.8
ABF 4.0-18					18	26				
ABF 6.0-12	6.0	10	GREEN	BLACK	12	20	6.8	8.0	3.9	3.5
ABF 6.0-18					18	26				
ABF 10.0-10	10.0	8	BROWN	IVORY	10	19	8.5	9.0	4.9	4.5
ABF 10.0-12					12	21				
ABF 10.0-18					18	27				
ABF 16.0-12	16.0	6	WHITE	GREEN	12	22	8.7	10.0	6.2	5.8
ABF 16.0-18					18	28				
ABF 25.0-15	25.0	4	BLACK	BROWN	15	27	11.0	12.0	7.9	7.5
ABF 35.0-20	35.0	2	RED	BEIGE	20	34	13.2	14.0	8.7	8.3
ABF 50.0-20	50.0	1	BLUE	GREEN	20	36	15.0	16.0	10.9	10.3
ABF 70.0-25	70.0	2/0	YELLOW	RED	25	42	17.0	16.5	14.3	13.5
ABF 95.0-25	95.0	3/0	RED	BLUE	25	44	20.0	19.0	15.6	14.8
ABF 120.0-27	120	4/0	BLUE		27	47.3	20.8	20.3	17.5	16.7
ABF 150.0-27	150	300MCM	YELLOW		27	52	24.5	25.0	20.6	19.6

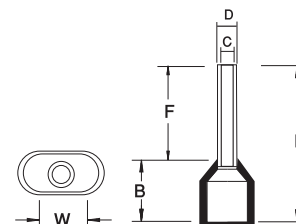

TWIN BOOTLACE FERRULES

Aftec Twin bootlace ferrules ensure reliable electrical connectors when terminating conductors in screw clamp terminal blocks and are used for twin wire containment. Color coding of the insulation is according to the wire size and the country standard. Designed with seamless barrel to contain loose wire strands for separator terminations which are easy to use by stripping the wire and sliding on to the end wire and crimping suitable for limited space panel applications.

Technical Data

Material : Copper
 Plating : Tin plated
 Insulation : Polyamide

MODEL NO.	WIRE RANGE		COLOR		DIMENSIONS					
	mm ²	AWG			F	L	W	B	D	C
					MM	MM	MM	MM	MM	MM
ABF 0.5-8X2C	0.5	20	WHITE	ORANGE	8	15	5.5	7	1.5	1
ABF 0.75-10X2C	0.75	18	WHITE	BLUE	10	17	6	7	2	1.8
ABF 1.0-10X2C	1.0	17	RED	YELLOW	10	18	6	8	2	1.8
ABF 1.5-8X2C	1.5	16	RED	BLACK	8	16	7	8	2.8	2.2
ABF 1.5-12X2C					12	20	7	8	2.8	2.2
ABF 2.5-10X2C	2.5	14	BLUE	GREY	10	19	9	9	4.2	3.9
ABF 2.5-13X2C					13	22	9	9	4.2	3.9
ABF 4.0-12X2C	4.0	12	GREY	YELLOW	12	23	10	11	4	3.9
ABF 6.0-14X2C	6.0	10	GREEN	BLACK	14	24.5	10.5	10	5.2	4.9
ABF 10.0-14X2C	10.0	8	BROWN	IVORY	14	26.2	13.2	12.2	7	6.5
ABF 16.0-14X2C	16.0	6	WHITE	GREEN	14	31	20	17	9	8.5

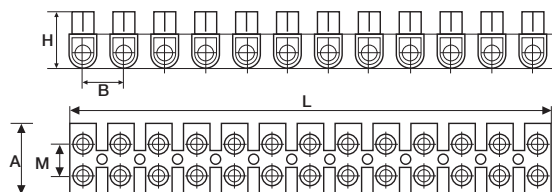
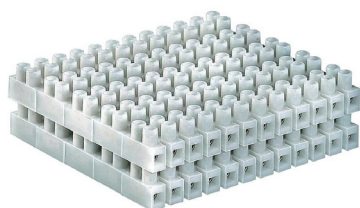

STRIP CONNECTOR

Aftec strip connectors are double row terminal strips which are cost effective. Simply strip and insert the wire and tighten the screw.

Technical Data:

Application : For wire to wire connectors in HVAC. Appliances, equipments and power distribution.
 Material : Polyamide 6.6
 Voltage Rating : 400 V
 Color : Black & White

MODEL NO.	CABLE SIZE		AMP	L	A	H	M	B	VOLT
	mm ²	AWG		MM					
APSC 412	4	12	3	93	16	12	6	8	400 V
APSC 612	6	10	6	115	15.7	13	6.5	9.5	
APSC 1012	10	8	10	126	20.2	15.5	8.4	10.5	
APSC 1612	16	6	30	171	26	20.5	12	14.5	
APSC 2512	25	4	60	192	30	26	13.5	16.5	
APSC 3512	35	2	80	205	33	27	15	17	

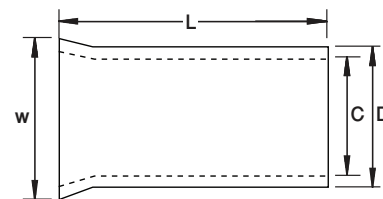

NON INSULATED BOOTLACE FERRULES

Aftec Non insulated Bootlace ferrules ensure reliable electrical connectors when terminating conductors in screw clamp terminal blocks. Designed with seamless barrel to contain loose wire strands for separator terminations which are easy to use by stripping the wire and sliding on to the end wire and crimping suitable for limited space panel applications.

Technical Data

Material : Copper

Plating : Tin plated

MODEL NO.	WIRE RANGE		DIEMESIONS			
	mm ²	AWG	L	W	D	C
			MM	MM	MM	MM
ABFNI 0.5-8	0.5	20	8	1.7	1.3	1.0
ABFNI 0.5-12			12			
ABFNI 0.75-8	0.75	18	8	1.9	1.5	1.2
ABFNI 0.75-12			12			
ABFNI 1.0-8	1.0	17	8	2.2	1.7	1.4
ABFNI 1.0-10			10			
ABFNI 1.5-8	1.5	16	8	2.5	2	1.7
ABFNI 1.5-10			10			
ABFNI 1.5-12			12			
ABFNI 1.5-18			18			
ABFNI 2.5-12	2.5	14	12	3.3	2.6	2.3
ABFNI 2.5-18			18			
ABFNI 4.0-12	4.0	12	12	3.9	3.2	2.8
ABFNI 4.0-18			18			
ABFNI 6.0-12	6.0	10	12	4.7	3.9	3.5
ABFNI 6.0-18			18			
ABFNI 10.0-12	10.0	8	12	5.8	4.9	4.5
ABFNI 10.0-18			18			
ABFNI 16.0-12	16.0	6	12	7.2	6.2	5.8
ABFNI 16.0-18			18			
ABFNI 25.0-15	25.0	4	15	9.1	7.9	7.5
ABFNI 35.0-20	35.0	2	20	10.2	8.7	8.3
ABFNI 50.0-20	50.0	1	20	12.7	10.9	10.3
ABFNI 70.0-25	70.0	2/0	25	15.8	14.3	13.5
ABFNI 95.0-25	95.0	3/0	25	17.3	15.6	14.8
ABFNI 120.0-27	120	4/0	27	20.2	17.3	16.7
ABFNI 150.0-27	150	300MCM	27	23	20.6	19.6